

1	494J-E10.01	Stator/Generator
4	ML494-E05.04	Nut 10mm
7	ML494-E05.07	Fan
9	ML494-E05.09	Grommet
11	ML494-E05.11	Bolt 5x16
12	ML494-E05.12	Shroud A
15	ML494-E05.15	Shroud B
22	ML494-E05.22	Shroud Gasket
23	ML494-E05.23	Starter Cable Clamp
25	ML494-E05.25	Fan Cover Assy

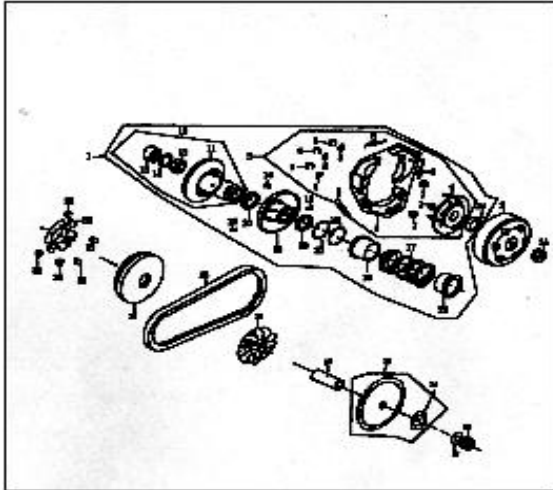

(Click line item in left column for more information)

(Prices and specifications subject to change)

Item	P/N	Description
1	ML494-E07.01	Clutch Assy
2	ML494-E07.02	Clutch Drum
25	ML494-E07.25	V-Belt (669x18x30)
27	ML494-E07.27	Washer 12mm
28	ML494-E07.28	Face Drive
29	ML494-E07.29	BOSS Drive Face
30	ML494-E07.30	Face Moveable Drive
31		

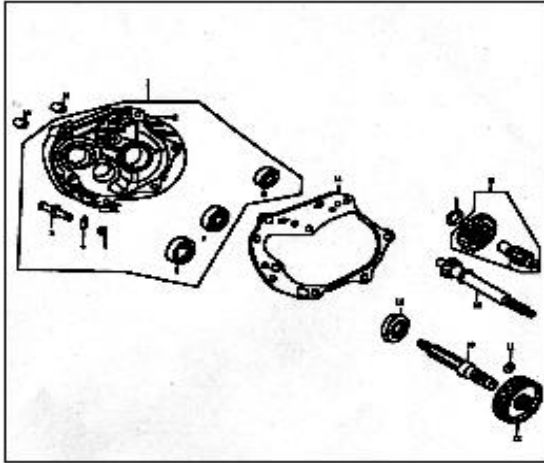

(Click line item in left column for more information)

(Prices and specifications subject to change)

Item	P/N	Description
1	ML494-E08.01	Gearbox Cover Assy
8	ML494-E08.08	Intermediate Shaft
10	ML494-E08.10	Axle Shaft
11	ML494-E08.11	Circlip
12	ML494-E08.12	Main Shaft Gear
13	ML494-E08.13	Oil Seal 27x42x7
14	ML494-E08.14	Gearbox Cover Gasket
15	ML494-E08.15	Main Drive Shaft
16	ML494-E08.16	Pin 10x20

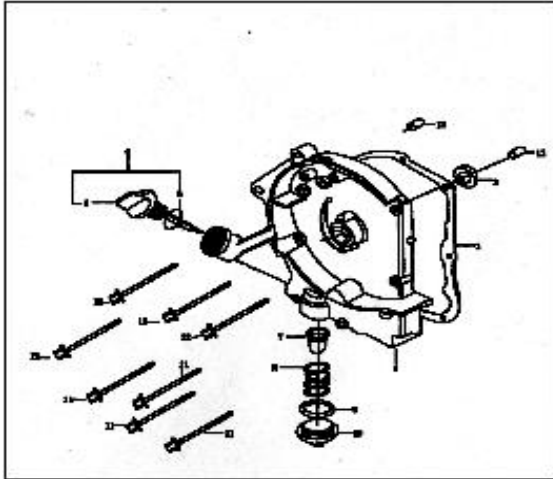

(Click line item in left column for more information)

(Prices and specifications subject to change)

Item	P/N	Description
1	ML494-E09.01	Right Crankcase Cover
2	ML494-E09.02	Oil Seal 16.4x30x5
3	ML494-E09.03	Crankcase Cover Gasket - Right
4	ML494-E09.04	Dipstick
7	125T-E06.04	Oil Filter
8	ML494-E09.08	Oil Filter Spring
9	ML494-E09.09	O-Ring 30*8mm
10	ML494-E09.10	Oil Filter Cover
11	ML494-E09.11	Bolt 6x100
12	ML494-E09.12	Bolt 6x85

